

5050(35)v15

5050(44)v15

5050(60)v15

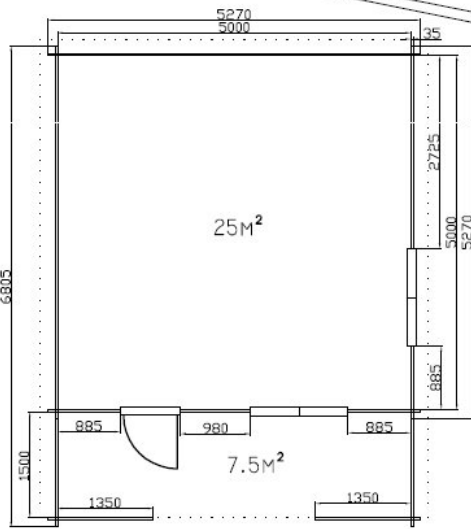
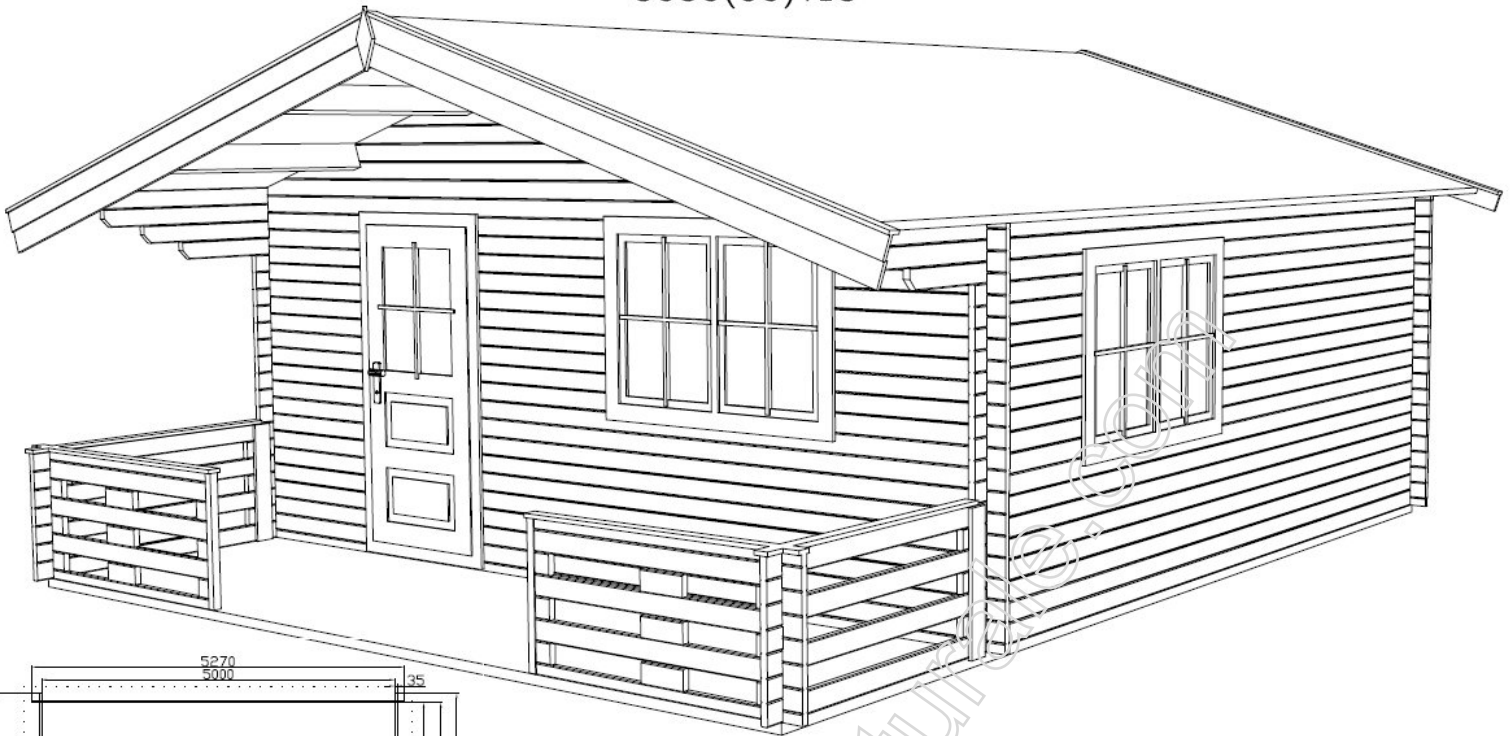

Garden house 5,00*5,00m(25m²) + roof 1,50m + veranda. Wall thickness 35, 44, 60mm with double plank profile from pine or fir wood. All wooden constructions are dried until 10–12%, without painting and impregnation. Door with glass and lock, windows with glass with simple opening system.

Other technical data:

- floor planks 22mm
- underground 100*40, 50*40mm
- roof planks 19mm
- rafter 240*60mm

Wall height: 2,10m

House height: 2,97m

Other modifications:

5050(35)Ls7

5050(44)Ls7

5050(60)Ls7

5040(35)s18v15

5040(44)s18v15

5040(60)s18v15

4050(35)Ls7

4050(44)Ls7

4050(60)Ls7

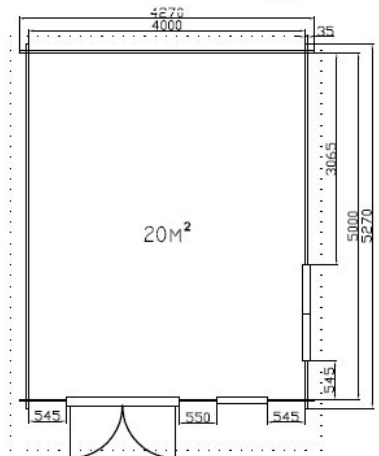
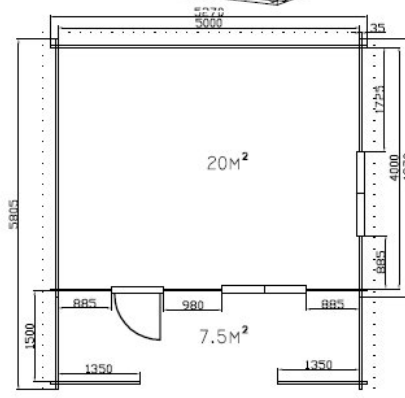
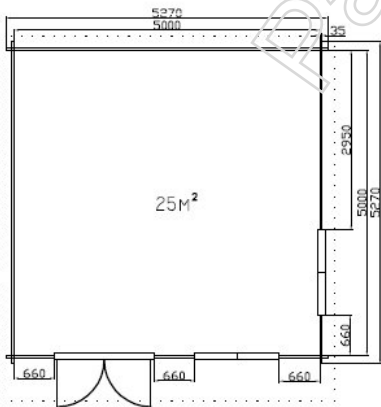
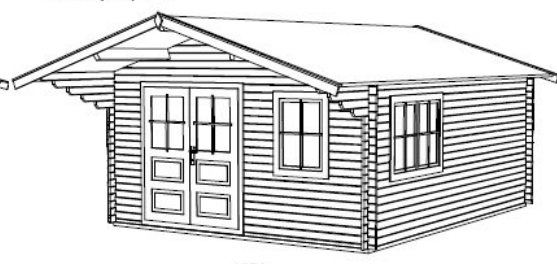

Garden house 5,00*5,00m(25m²) + roof 0,70m with double door.

Garden house 5,00*4,00m(20m²) + roof 1,80m and veranda 1.5m(7,5m²).

Garden house 4,00*5,00m(20m²) + roof 0,7m with double door.